

TEMPORARY GRAVEL CONSTRUCTION ENTRANCE

PLATE 4.03a
SOURCE: EROSION DRAW

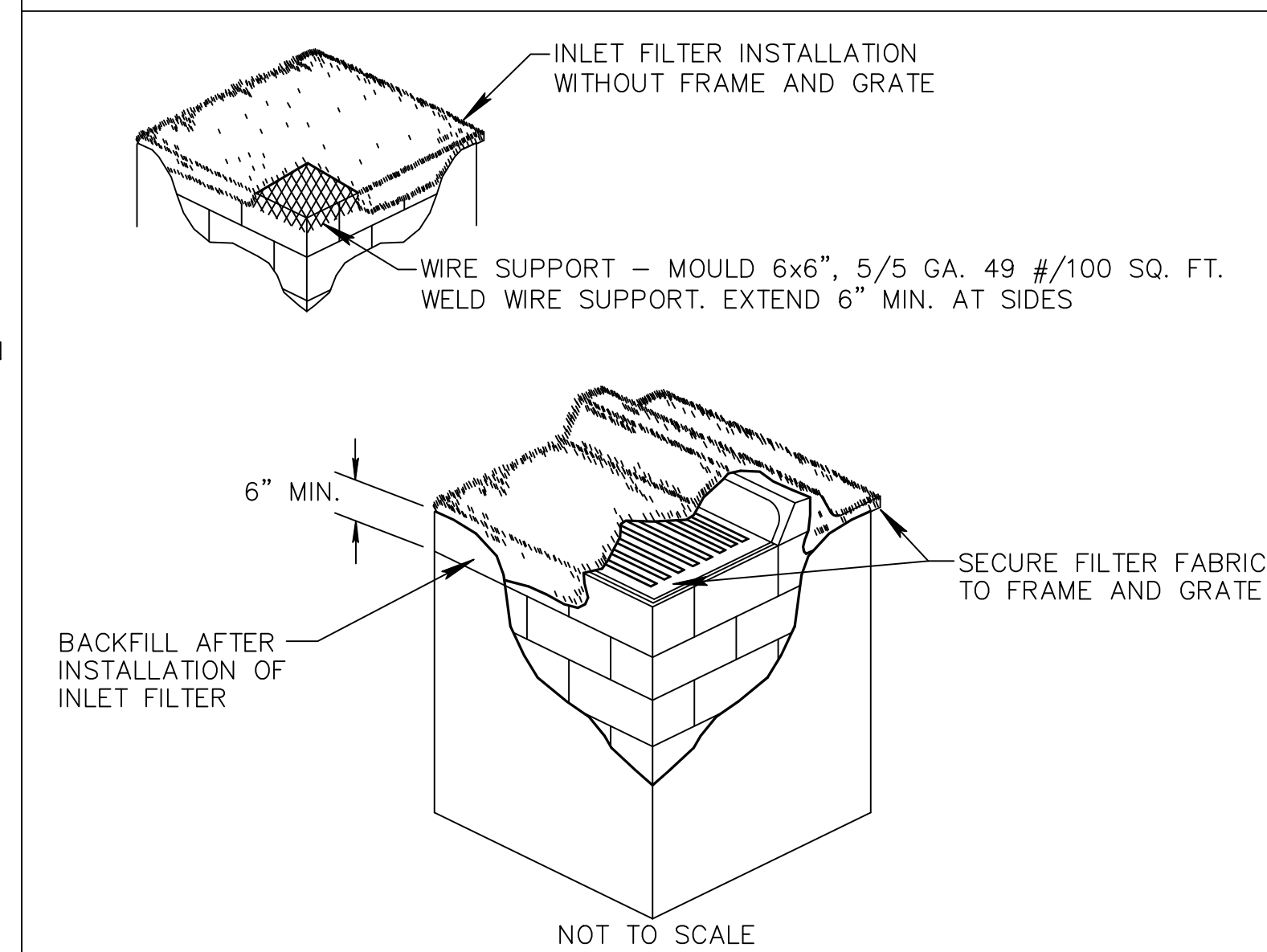

INLET FILTER DETAIL

N.T.S.

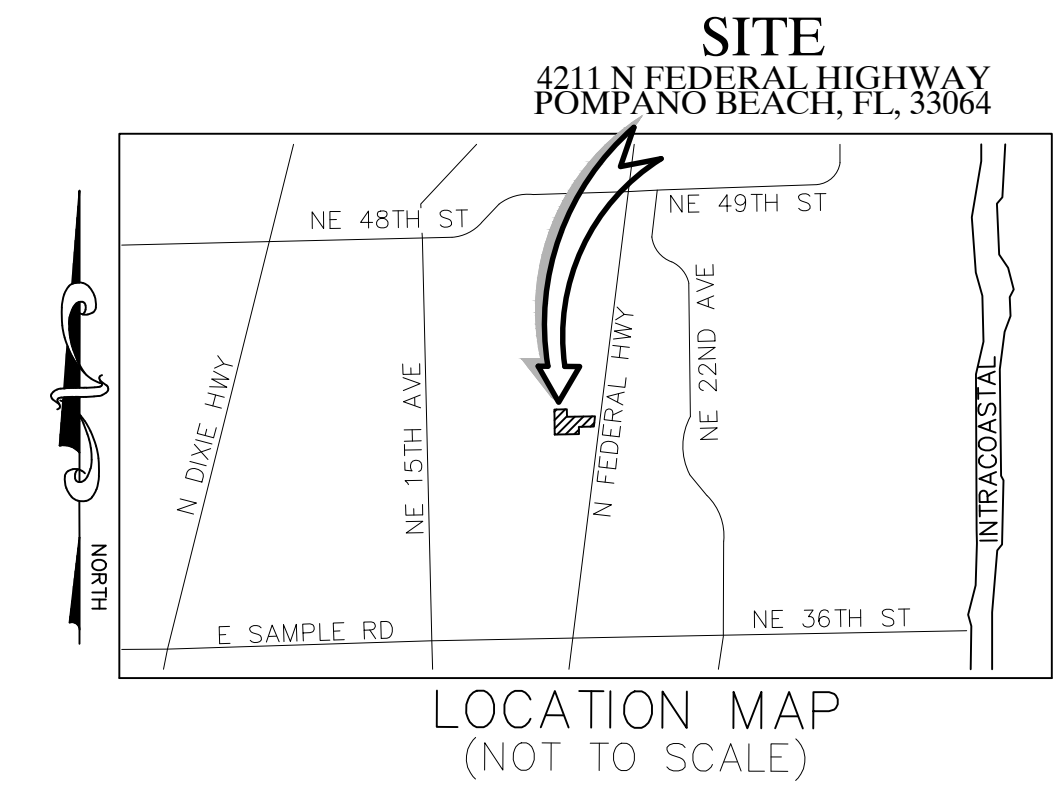
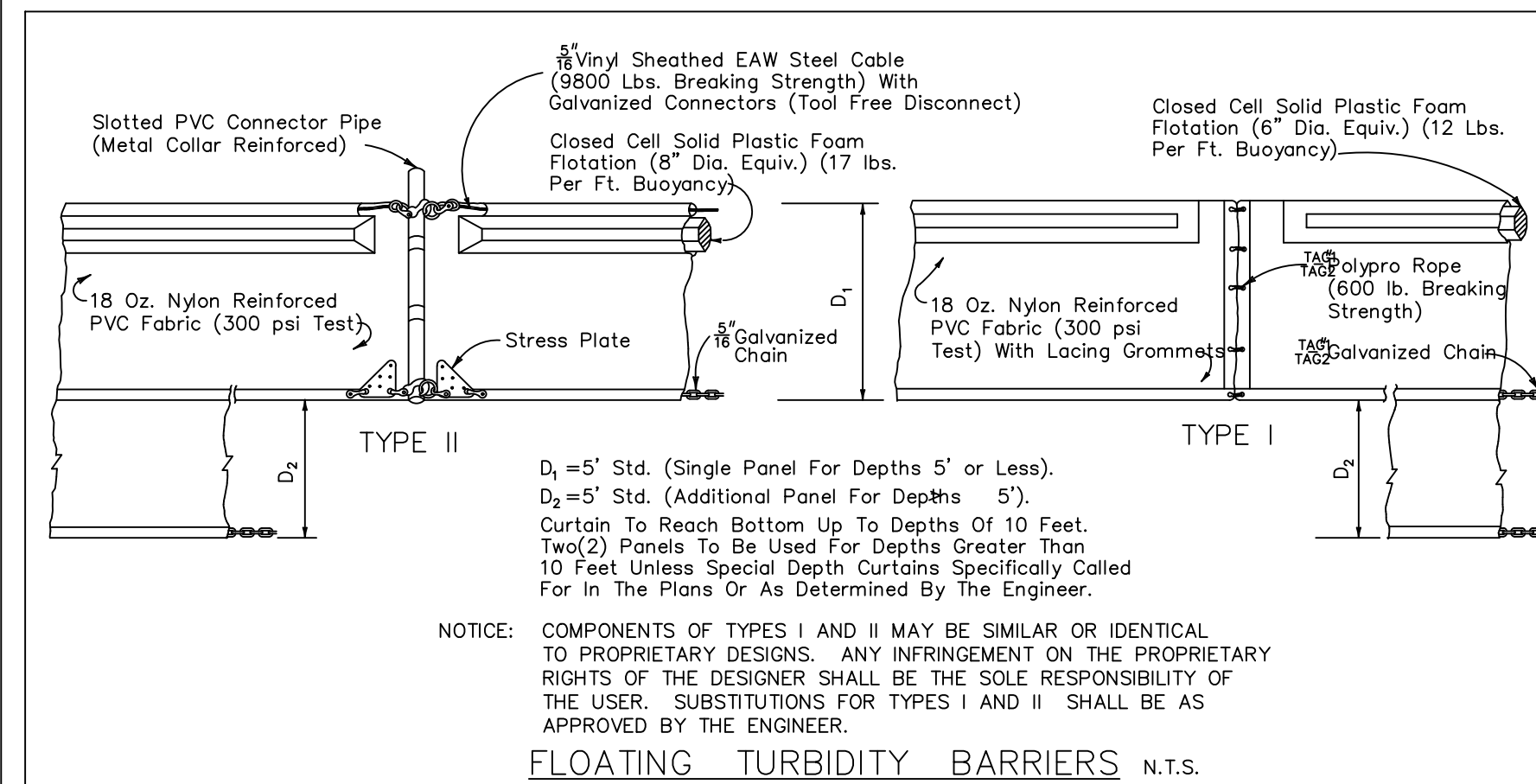

LEGEND

- BOUNDARY OF
POLLUTION PREVENTION
- SILT FENCE/HAY BALES (PER
F.D.O.T. INDEX 103)
- INLET FILTER (REQUIRED FOR
ALL INLETS DOWNSTREAM OF
DISTURBED AREAS)

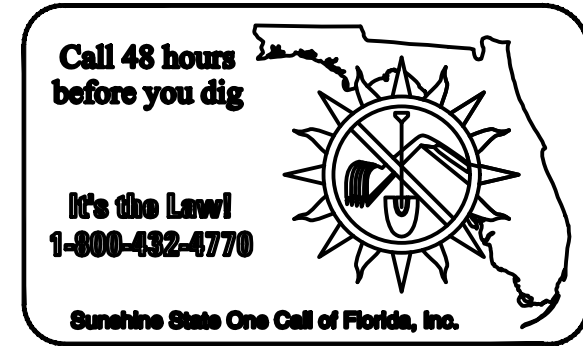

GRAPHIC SCALE

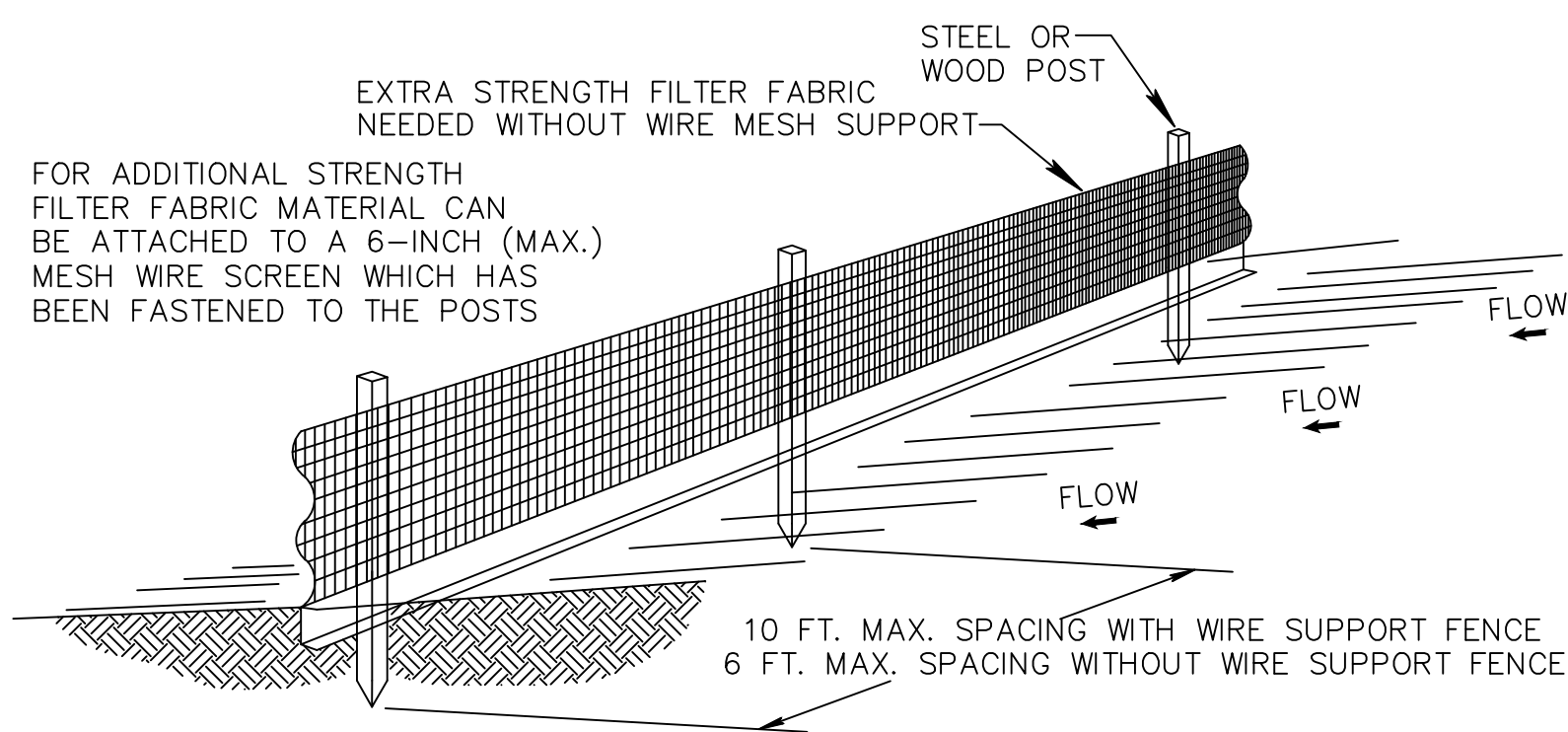
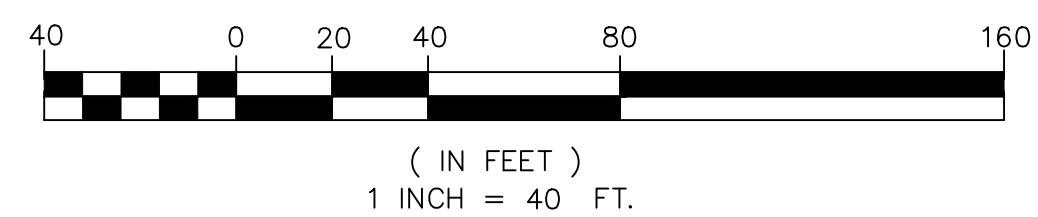

NOTES:

1. THE HEIGHT OF A SILT FENCE SHALL NOT EXCEED 36 INCHES (90 CM).
2. THE FILTER FABRIC SHALL BE PURCHASED IN A CONTINUOUS ROLL CUT TO THE LENGTH OF THE BARRIER TO AVOID THE USE OF JOINTS.
3. POSTS SHALL BE SPACED A MAXIMUM OF 10 FEET (3 M) APART AT THE BARRIER LOCATION AND DRIVEN SECURELY INTO THE GROUND A MINIMUM OF 12 INCHES (30 CM). WHEN EXTRA STRENGTH FABRIC IS USED WITHOUT THE WIRE SUPPORT FENCE, POST SPACING SHALL NOT EXCEED 6 FEET (1.8 M).
4. A TRENCH SHALL BE EXCAVATED APPROXIMATELY 4 INCHES (10 CM) WIDE AND 4 INCHES (10 CM) DEEP ALONG THE LINE OF POSTS AND UPSLOPE FROM THE BARRIER.
5. WHEN STANDARD STRENGTH FILTER FABRIC IS USED, A WIRE MESH SUPPORT FENCE SHALL BE FASTENED SECURELY TO THE UPSLOPE SIDE OF THE POSTS USING HEAVY DUTY WIRE STAPLES AT LEAST 1 INCH (25 MM) LONG, TIE WIRES, OR HOG RINGS. THE WIRE SHALL EXTEND INTO THE TRENCH A MINIMUM OF 2 INCHES (5 CM) AND SHALL NOT EXTEND MORE THAN 36 INCHES (90 CM) ABOVE THE ORIGINAL GROUND SURFACE.
6. THE STANDARD STRENGTH FILTER FABRIC SHALL BE STAPLED OR WIRED TO THE FENCE, AND 8 INCHES (20 CM) OF THE FABRIC SHALL BE EXTENDED INTO THE TRENCH. THE FABRIC SHALL NOT EXTEND MORE THAN 36 INCHES (90 CM) ABOVE THE ORIGINAL GROUND SURFACE.
7. THE TRENCH SHALL BE BACKFILLED AND THE SOIL COMPACTED OVER THE FILTER FABRIC.

SILT FENCE INSTALLATION DETAIL D 9.1a

(Sheet 1 of 2)

N.T.S.

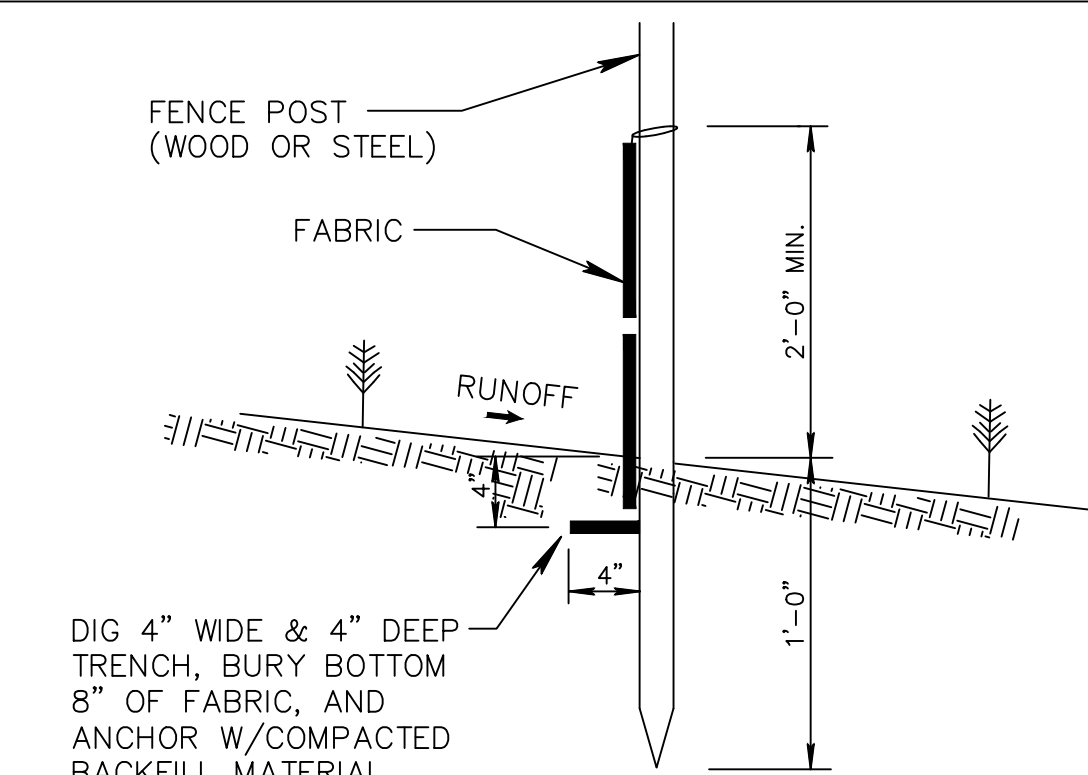

SILT FENCE SECTION
NOT TO SCALE

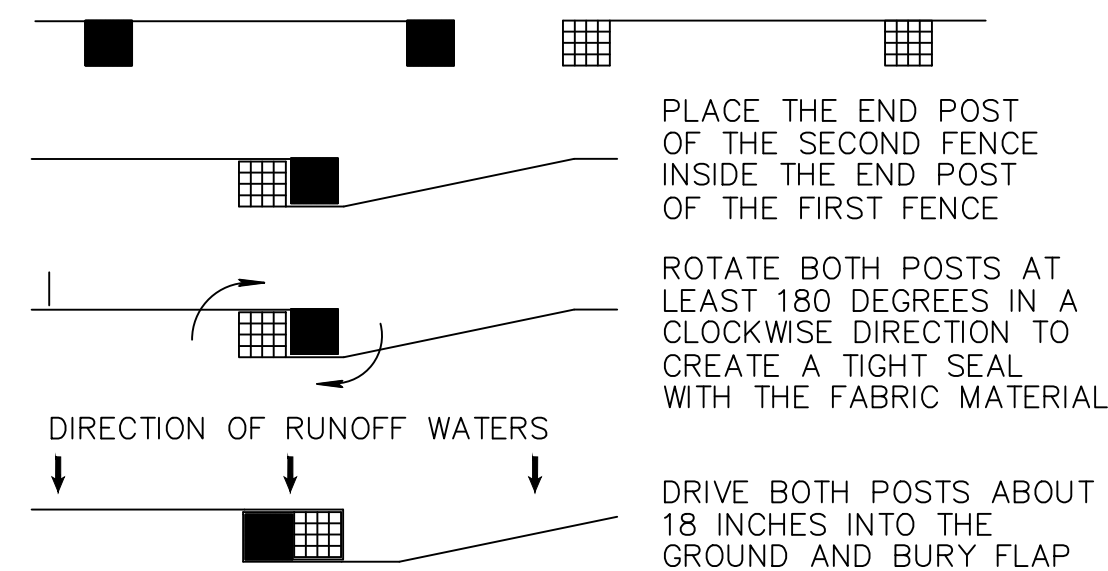

ATTACHING TWO SILT FENCES

NOT TO SCALE

SILT FENCE INSTALLATION DETAIL D 9.1b

(Sheet 2 of 2)

N.T.S.

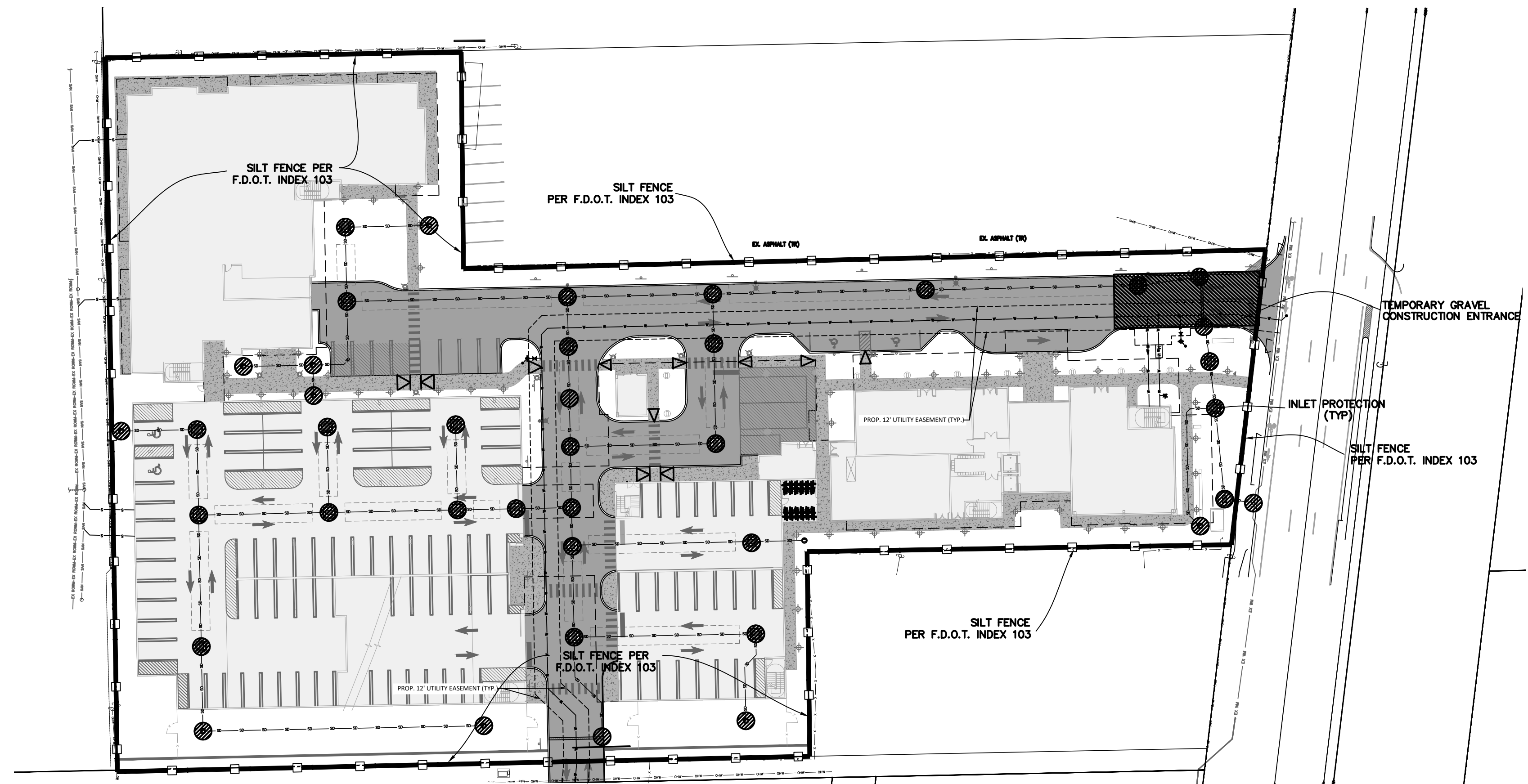

POLLUTION PREVENTION DETAIL

REV PER CITY COMMENTS	12/16/25	DJP
REV PER CITY COMMENTS	10/27/25	DJP
REV PER CITY COMMENTS	08/25/25	DJP
REVISIONS	DATE	BY
FILE NAME 11146ENG.dwg		



CAULFIELD & WHEELER, INC.
CIVIL ENGINEERING
LANDSCAPE ARCHITECTURE - SURVEYING
7900 GLADES ROAD - SUITE 100
BOCA RATON, FLORIDA 33434
PHONE (561)-392-1991 / FAX (561)-750-1452

THE SATORI
4211 N FEDERAL HIGHWAY
PROPOSED POLLUTION PREVENTION
PLAN AND DETAILS
POMPANO BEACH, FL, 33064

DATE	05/28/25
DRAWN BY	DJP
F.B./ PG.	----
SCALE	1"= 40'

MATTHEW V. KAHN
PROFESSIONAL ENGINEER
LICENSE NO. 82227
STATE OF FLORIDA
- FOR THE FIRM -
DATE

JOB # 11146
SHT.NO.
PP-1
OF 16 SHEETS